

Copyright© 2005 by Big Bike Parts, Inc. No part of this instruction sheet may be reproduced without the written permission of Big Bike Parts Inc.®

Lower Fog Light Kit  
Part No. 52-604  
Part No. 52-704

Fits Honda  
GL1800 Gold Wing

Revised 07/31/07

TOOLS REQUIRED:	PHILLIPS SCREWDRIVER SIDE CUTTERS	5MM WRENCH 8MM WRENCH	FILE FLAT BLADE SCREWDRIVER
-----------------	--------------------------------------	--------------------------	--------------------------------

1. PLACE THE BIKE ON ITS CENTER STAND.
2. DISCONNECT THE NEGATIVE BATTERY CABLE.
3. USING 5MM ALLEN WRENCH REMOVE THE SIX BOLTS (1A) FROM THE FRONT COWL (1B).
4. REMOVE THE TWO TRIM CLIPS (1C) AND REMOVE THE FRONT COWL (1B).
5. USING SIDE CUTTERS OR UTILITY KNIFE REMOVE THE KNOCK OUTS (1D) FROM FRONT COWL (1B). USE A FILE TO SMOOTH EDGES.
6. INSTALL THE GROMMETS (2A) IN THE HOLES ON THE RIGHT (2B) AND LEFT (2C) MOUNTING BRACKETS AS SHOWN IN FIGURE 2.
7. INSTALL THE RIGHT BRACKET (3A) ON THE FOG LAMP (3B) AS SHOWN IN FIGURE 3. DO THE SAME FOR THE LEFT SIDE.
8. USING THE 8MM WRENCH REMOVE THE TWO BOLTS (4A) HOLDING THE PLASTIC TRIM PIECES (4B) ON. INSTALL THE RIGHT FOG LAMP (4C) BY USING THE SHORT FLANGE COLLARS (4D), SHORT SPACER ('01 - '05 MODELS ONLY) (4E), SHORT FLANGE BOLTS (4F) AND WASHERS (4G). PLUG THE 2-PIN CONNECTOR INTO THE MOTORCYCLES 2-PIN GRAY CONNECTOR (4H). THE MOTORCYCLE CONNECTOR MAY BE TAPED TO THE BIKE. THIS TAPE WILL HAVE TO BE REMOVED TO LENGTHEN WIRES. REFER TO FIGURE 4.
9. USING THE 8MM WRENCH REMOVE THE TWO BOLTS (5A) HOLDING THE PLASTIC TRIM PIECE (5B) ON. INSTALL THE LEFT FOG LAMP (5C) BY USING THE SHORT FLANGE COLLARS (5D), THE TWO MEDIUM SIX SPACERS (5E), THE LONG SPACER (5F), THE LONG FLANGE BOLT (5G), AND WASHERS (5H). PLUG THE 2-PIN CONNECTOR INTO THE MOTORCYCLES 2-PIN GRAY CONNECTOR (5I). REMOVE THE PLUG COVER FIRST. THE MOTORCYCLE CONNECTOR MAY BE TAPED TO THE BIKE. THIS TAPE WILL HAVE TO BE REMOVED TO LENGTHEN WIRES. REFER TO FIGURE 5.
10. REMOVE THE LEFT SIDE FAIRING TRIM MOLDING (6A).
11. REMOVE THE ALLEN BOLT (6B) AND REMOVE THE LEFT CONTROL PANEL (6C).
12. REMOVE THE SWITCH COVER (7E) ON THE BACK OF CONTROL PANEL (7C).
13. REMOVE THE TWO SCREWS (7A) HOLDING THE SWITCH HOLE COVER (7B) TO THE CONTROL PANEL (7C).
14. INSTALL THE SWITCH (7D) USING THE SCREWS (7A) REMOVED IN THE PREVIOUS STEP.
15. PLUG THE 4-PIN CONNECTOR (6D) FROM THE SWITCH INTO THE RELAY HARNESS (6E). PLUG THE RELAY HARNESS (6E) TO THE MOTORCYCLES ACCESSORY BLACK 4-PIN CONNECTOR (6F).

**NOTE: THIS KIT COMES WITH A RELAY (6G) AND A JUMPER PLUG (6G). IF THE RELAY IS USED, THE KIT WILL FUNCTION AS OEM AND THE FOG LIGHTS WILL TURN OFF WITH THE HIGH BEAMS. IF THE JUMPER PLUG IS USED, THE FOG LIGHTS WILL ONLY TURN OFF WITH THE SWITCH.**

16. BEFORE INSTALLING ALL REMOVED COMPONENTS CHECK TO MAKE SURE THE LIGHTS WORK AND THAT THEY ARE AIMED CORRECTLY. TO CHECK TO MAKE SURE THEY ARE AIMED CORRECTLY MAKE SURE THE BIKE IS LEVEL AND ABOUT 16 FEET FROM A WALL. THEN MEASURE FROM THE GROUND TO THE CENTER OF FOG LAMP, AND MAKE A MARK ON WALL TO THAT MEASUREMENT. IF THE LIGHTS NEED ADJUSTMENT YOU CAN SCREW IN OR OUT THE ADJUSTMENT SCREW ON EACH MOUNTING BRACKET.
17. REINSTALL THE CONTROL PANEL & FAIRING TRIM MOLDING IN THE REVERSE OF REMOVAL.

**BULB REPLACEMENT:** REPLACE BULBS WITH BIG BIKE PARTS #10-2604. DO NOT REPLACE WITH A WATTAGE HIGHER THAN 35 WATTS. TO REPLACE BULB YOU MUST REMOVE THE BACK PLATE OF THE FOG LIGHT, REMOVE THE RETAINING CLIP INSIDE AND UNPLUG BULB FROM CONNECTOR. MAKE SURE WHEN YOU REPLACE BACK PLATE THAT NO WIRES ARE PINCHED.

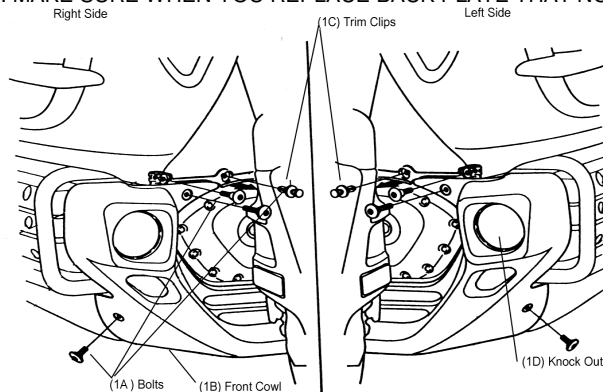

FIG 1

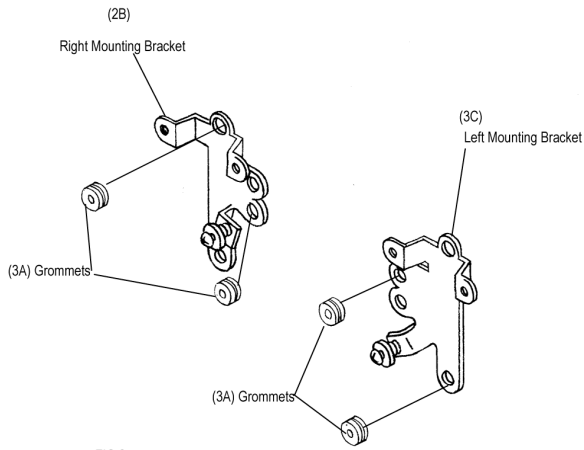

FIG 2

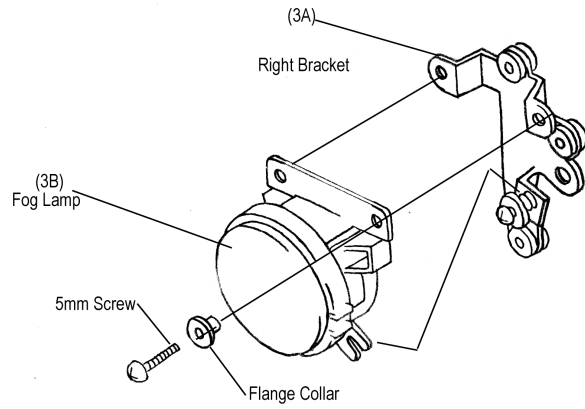

FIG 3

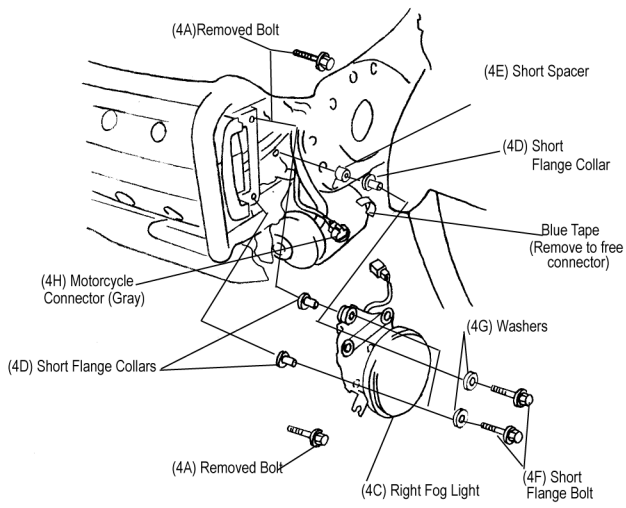

FIG 4

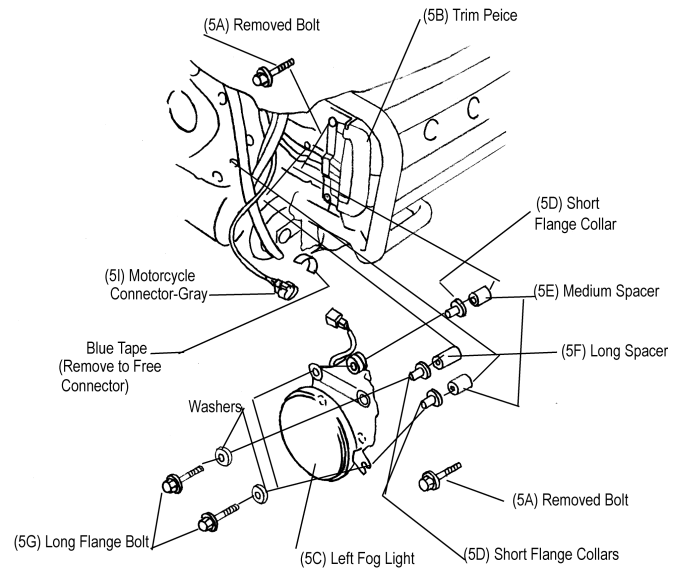

FIG 5

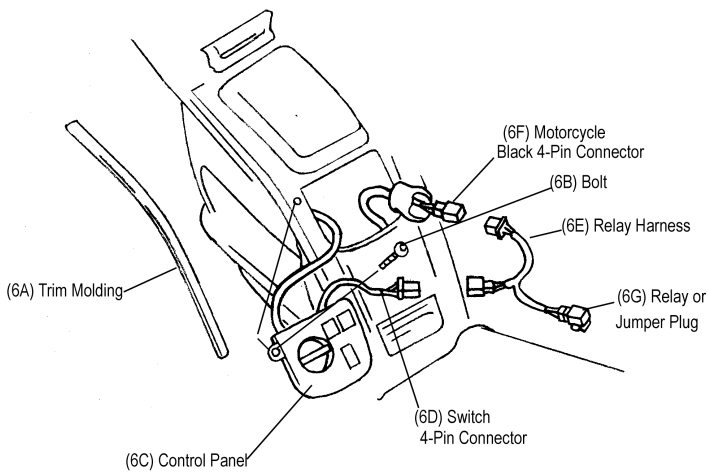

FIG 6

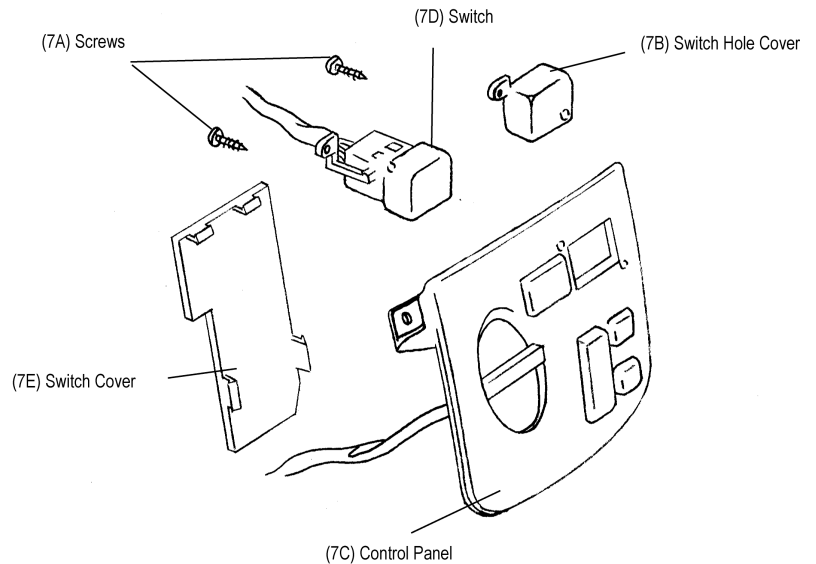

FIG 7