

Copyright© 2006 by Big Bike Parts, Inc. No part of this instruction sheet may be reproduced without the written permission of Big Bike Parts, Inc.

REVISED 04/25/07

**TOOLS REQUIRED:**

4MM ALLEN WRENCH	10MM WRENCH
5MM ALLEN WRENCH	9/16 WRENCH & SOCKET
6MM ALLEN WRENCH	12MM WRENCH

**COMPONENT LIST:**

A (4) 3/8" X 1.25" LONG BOLT	F (2) M6 X 18MM SOCKET HEAD CAP SCREW	L (1) RECEIVER
B (8) 3/8" FLAT WASHER	G (1) HITCH FRAME ASSEMBLY	M (1) 3/8" X 3/4" LONG BOLT
C (4) 3/8" NYLOC NUT	H (1) HITCH PIN	N (1) 3/8" NUT
D (2) 1" THREE PIECE CLAMP	J (1) HAIR PIN	O (2) 1/4" WASHERS
E (1) "T" BRACKET	K (1) 1 7/8" BALL	

**INSTALLATION:**

1. PLACE YOUR BIKE ON ITS CENTER STAND.
2. USING A 5MM ALLEN WRENCH REMOVE THE FIVE SCREWS (1A) HOLDING THE REAR SHROUD (1B) TO THE SADDLEBAGS.
3. USING A 10MM WRENCH REMOVE THE TWO BOLTS (1C) HOLDING THE SADDLEBAG FRAME CROSS BRACE (1D) TO THE SADDLEBAG FRAME.
4. USING A 6MM ALLEN WRENCH LOOSEN (DO NOT REMOVE) THE TWO LEFT SIDE MUFFLER CLAMP BOLTS (2A). USING THE 12MM WRENCH REMOVE THE MUFFLER BRACKET BOLT (2C). THIS WILL ALLOW YOU TO SWING THE MUFFLER (2B) DOWN OUT OF THE WAY.
5. REPEAT STEP #4 FOR THE RIGHT SIDE.
6. ATTACH THE 1" THREE PIECE CLAMPS 'D' TO THE SADDLEBAG GUARDS (2D). LEAVE LOOSE TO ALLOW FOR MOVEMENT.
7. SLIDE THE HITCH FRAME ASSEMBLY 'G' IN PLACE (3A).
8. REATTACH THE LEFT AND RIGHT SIDE MUFFLER BY REVERSING STEPS 4 & 5.
9. INSTALL THE "T" BRACKET 'E' OVER THE BAG FRAME CROSS BRACE, USING M6 X 18MM SOCKET HEAD CAP SCREWS 'F' AND TIGHTEN USING 10MM WRENCH.
10. LOOSELY SECURE THE LEFT SIDE HITCH MOUNTING TAB TO THE 1" THREE PIECE CLAMP 'D'. USING 3/8" X 1 1/4" LONG BOLTS 'A', 3/8" FLAT WASHERS 'B', 3/8" NYLOC HEX NUTS 'C'. LEAVE BOLTS LOOSE UNTIL LATER. (DO THE SAME ON RIGHT SIDE)
11. INSTALL THE "T" BRACKET 'E' TO THE HITCH FRAME ASSEMBLY 'G', USING THE 3/8" X 1 1/4" LONG BOLTS 'A', 3/8" FLAT WASHERS 'B', AND NYLOC NUTS 'C'.
12. TIGHTEN DOWN ALL THE NUTS AND BOLTS.
13. REPLACE THE REAR SHROUD (1B) BY REVERSING STEP #2.
14. FASTEN THE 1 7/8" HITCH BALL 'K' TO RECEIVER 'L' AND SECURELY TIGHTEN.
15. SLIDE THE RECEIVER 'L' INTO THE RECEIVER TUBE, PLACING THE HITCH PIN 'H' THROUGH BOTH AND SECURE WITH HAIR PIN 'J'.
16. SNUG ANTI CHATTER BOLT 'M' (DO NOT OVER-TIGHTEN) AND TIGHTEN JAM NUT 'N'.

**CAUTION:** FOR USE IN CONJUNCTION WITH PROFESSION MANUFACTURED MOTORCYCLE TRAILERS. DO NOT EXCE THE TOTAL RECOMMENDED TRAILER LOADS OF YOUR MOTORCYCLE OR MOTORCYCLE TRAILER MANUFACTURE

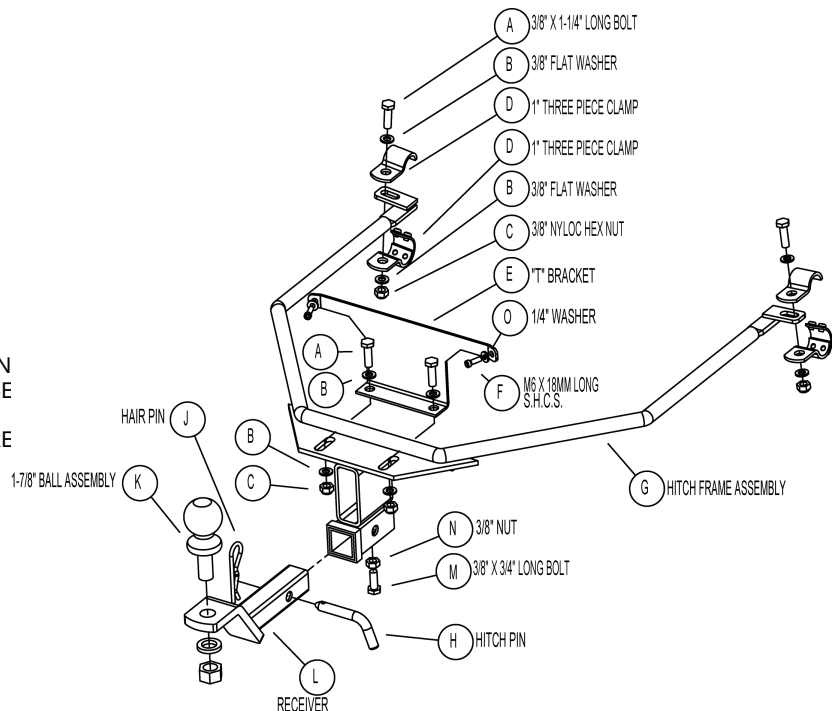

**NOTE:** YOUR RECEIVER HITCH COMES WITH TWO MOUNTING HOLES ALLOWING YOU TO INSTALL A MUD FLAP BEHIND THE RECEIVER TUBE PLATE.

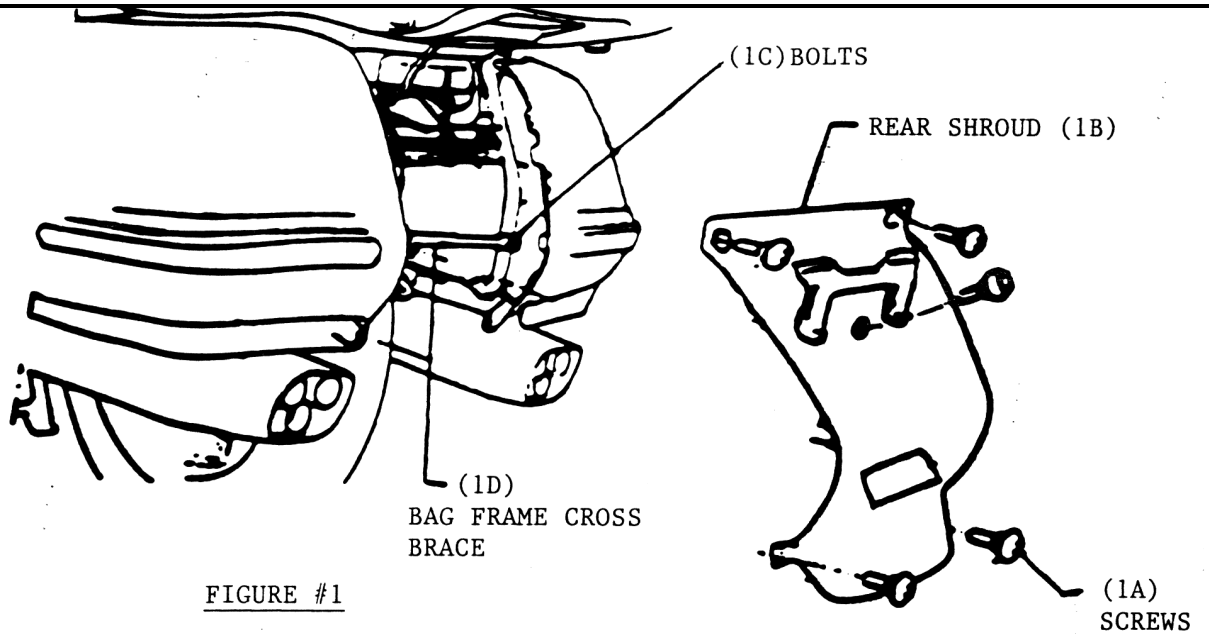
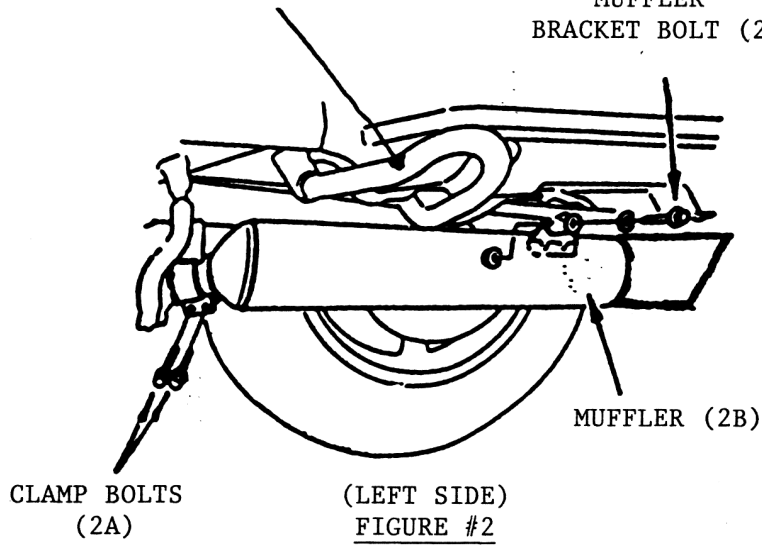

FIGURE #1

SADDLE BAG  
GUARDS (2D)

MUFFLER  
BRACKET BOLT (2C)



1" THREE PIECE CLAMP

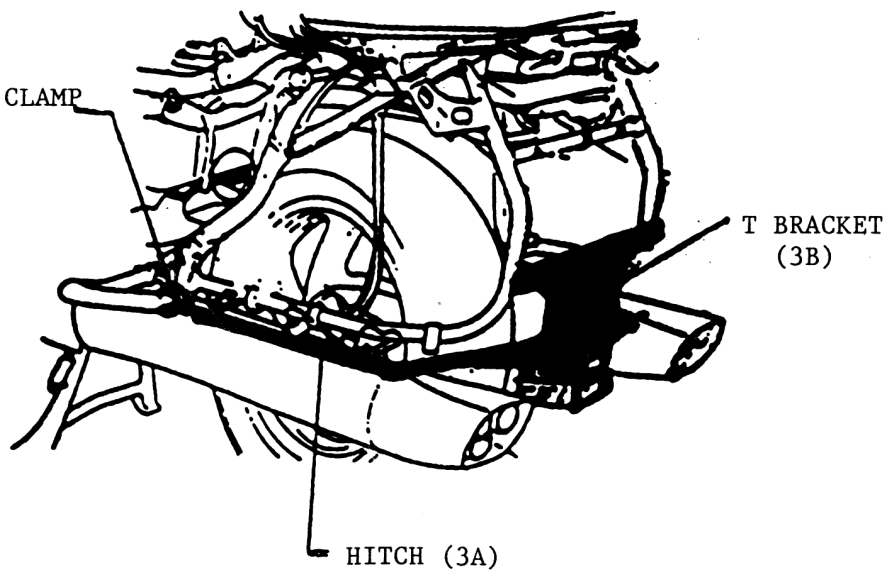

FIGURE # 3